

Sauna heater 43.FN

For family sauna

Outer shell:	bright high-grade steel or powder-coated steel sheet in anthracite pearl effect
Inner shell:	hot-dip aluminium coated sheet
Rear wall:	hot-dip aluminium coated sheet
Stone basket:	high-grade steel
Terminal box:	hot-dip aluminium coated sheet
Stone filling:	15 kg incl.

Bracket for wall mounting for secured stand resp. for wall mounting at certain floor level included.

Connection diagram

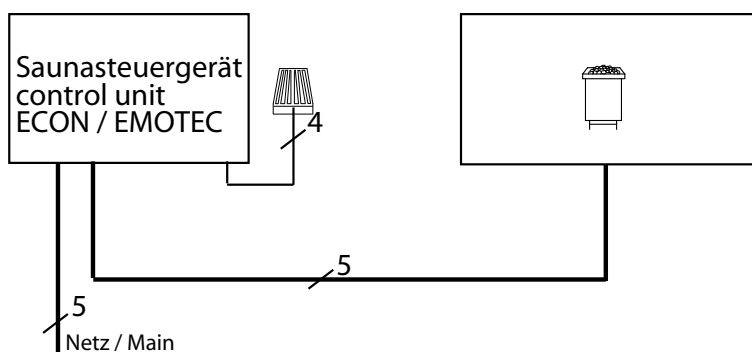

CE  IP x4 
MADE IN GERMANY

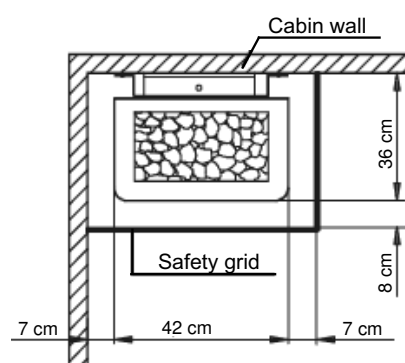
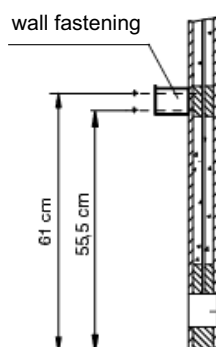
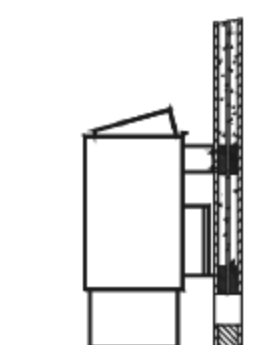

Art.-No.	Outer shell	Capacity acc. DIN	Electrical Connection	Fuse control unit in A	Installation dimensions H/W/D cm	For cabin size	Minimum dimensions of air intake and exhaust vents	Weight without stones without package	Stone filling	Connecting cable main - control unit in mm ²	Connecting cable control unit - heater in mm ²	Power switch gear (LSG) needed	For operation with control units
94.2234	anthracite	6,0 kW	3N AC 50 Hz 400 V	3 x 16	71 / 42 / 36	6 - 8 m ³	35 x 4 cm **	18,0 kg	15 kg	5 x 2,5 ²	5 x 1,5 ²	no	ECON A1 ECON A2 ECON H2 EMOTEC B6000 EMOTEC DC9000 EMOTEC DC9000 DB/DL EMOTEC HCS 9003 EMOTEC HCS 9003 DB/DL
94.2264	high-grade steel	7,5 kW				7 - 10 m ³	35 x 5 cm **	18,5 kg					
94.2235	anthracite	9,0 kW				9 - 14 m ³	35 x 6 cm **	19,0 kg					
94.2265	high-grade steel												

All cross sections of a line are minimum diameters in mm² (Copper line)

* or in accordance with the instructions of the cabin manufacturer

Subject to technical modifications